

TECHNICAL DATA SHEET – INSTALLATION

Aluminum batten accessories
MAA Serie

BC Bracket – 2 in Batten

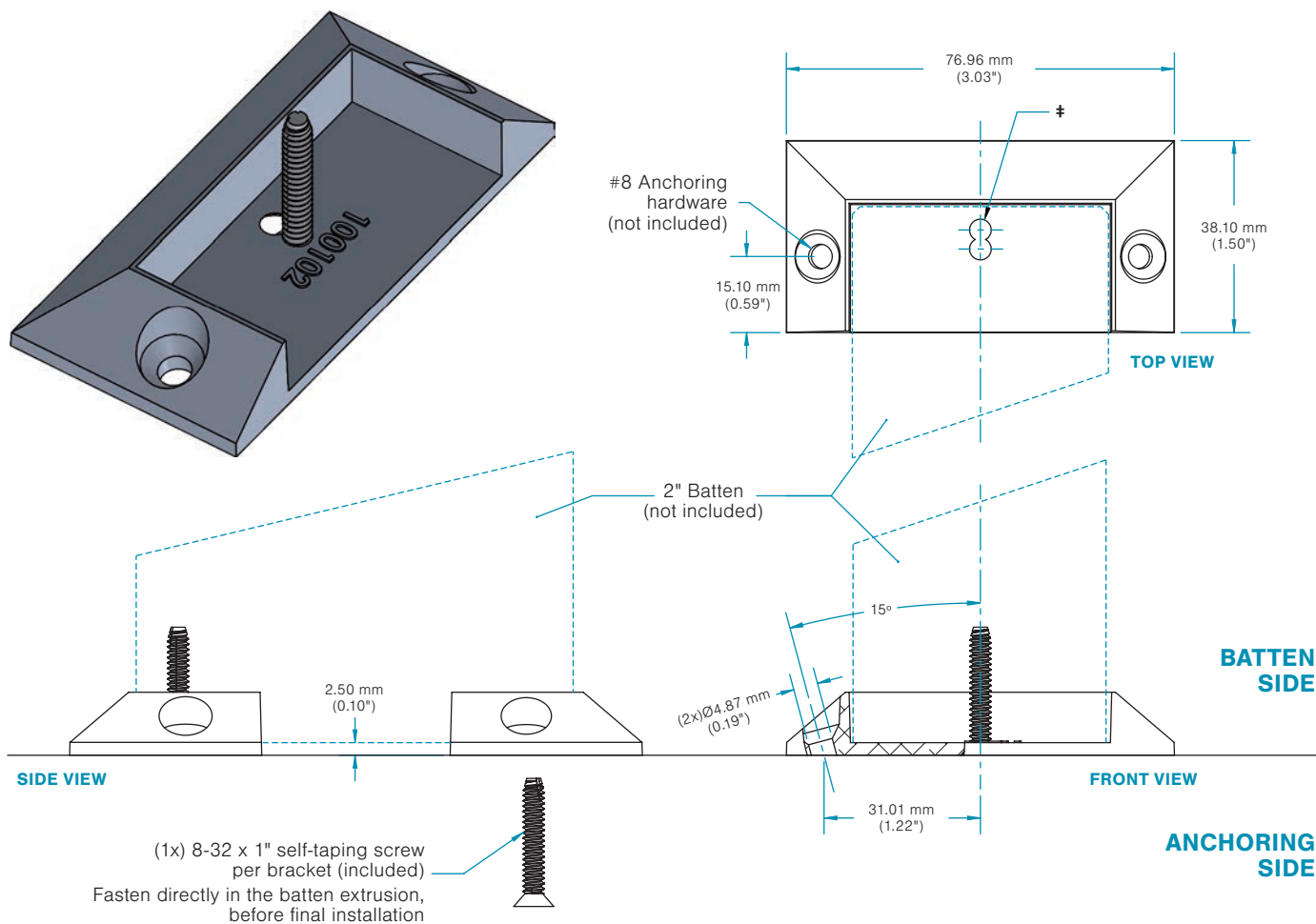

General Specifications

MODEL

BC Bracket - 2 in Batten

MATERIAL

A380 aluminum

FINISH

RAL 7022 Matte

WEIGHT

Kit: 0.14lb | 0.066kg

NOTE

- 1) Make sure to remove end cap (if applicable) prior to install brackets to each batten end.
- 2) Fasten the bracket to the batten before installing on wall/ground/ceiling.

IMPORTANT

Always check local building regulations before installing Maibec aluminum battens.

* Make sure to use proper hole when fastening BC brackets to the batten. There should be no space between the two parts.